

Spring for innovation

Engineering Form

SPACE REQUIRED

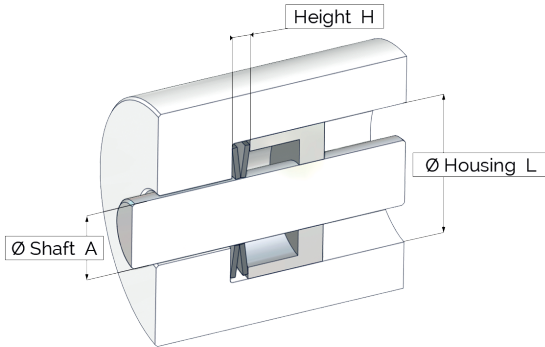

Housing diameter L* :mm
 Shaft diameter A* :mm
 Minimum working height H :mm
 Maximum working height H :mm

Centering mode

- Housing L
- Shaft A



Free height H₀

H₀ min :mm
 H₀ max :mm

LOADS UNDER WORKING HEIGHTS

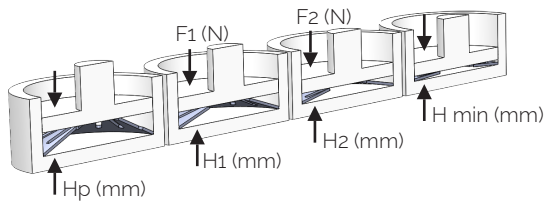

Preloading height H_p :mm
 Working height H₁* :mm Load F₁* :N
 Working height H₂ :mm Load F₂ :N
 Working height H min :mm

ELASTICITY CURVE

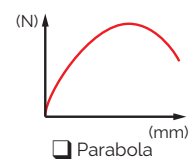
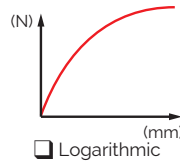
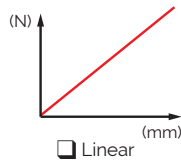
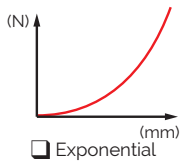

ENVIRONMENT

Operating temperature :

Mini* :°C Maxi* :°C

- Spring operates in oil
- Spring must be stainless
- Spring should not be magnetic
- Spring must be conductive

Surrounding chemical substances :

Required raw material :

FATIGUE

- Static application
- Dynamic application
 - Operating frequency :Hz
 - Number of cycles :

QUANTITIES

Prototypes :

Pre serie :

Serie* :

Annual :

APPLICATION DESCRIPTION

.....

.....

.....

IDENTIFICATION

Last Name* : First Name* :

Company* : Function :

Full address :

.....

Email* : Phone :

*Required field